

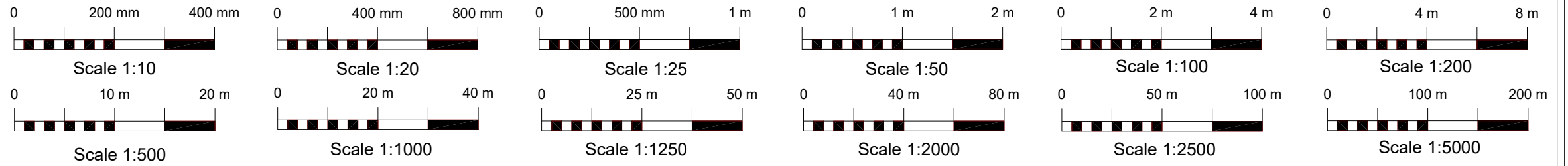

Scale 1:1250  
Site Location



## Proposed First Floor Plan

### BEAM A

203x203x46kgUC S275 (see attached calcs)

Total length 6310mm with with splice plated connection. See attached connection details.

Sections of BEAM A

2800mm & 3510mm = 6310mm total length

**ALL DIMENSIONS TO BE CHECKED BY BUILDER**

ANY QUESTIONS, ANY DOUBT - ASK 07922 148 701

### BEAM B

203x102x23kgUB S275 (see attached calcs)

4170mm total length

**ALL DIMENSIONS TO BE CHECKED BY BUILDER**

ANY QUESTIONS, ANY DOUBT - ASK 07922 148 701

All beams & connections to be treated with red oxide paint by fabricator.

### SPLICE CONNECTION

Flange plates x 2

10mm thick S275  
170x465mm  
24 bolts/nuts M16 HSFG 18mm dia holes

Web plate x 1

10mm thick S275  
150x465mm  
12 bolts/nuts M16 HFG 18mm dia holes

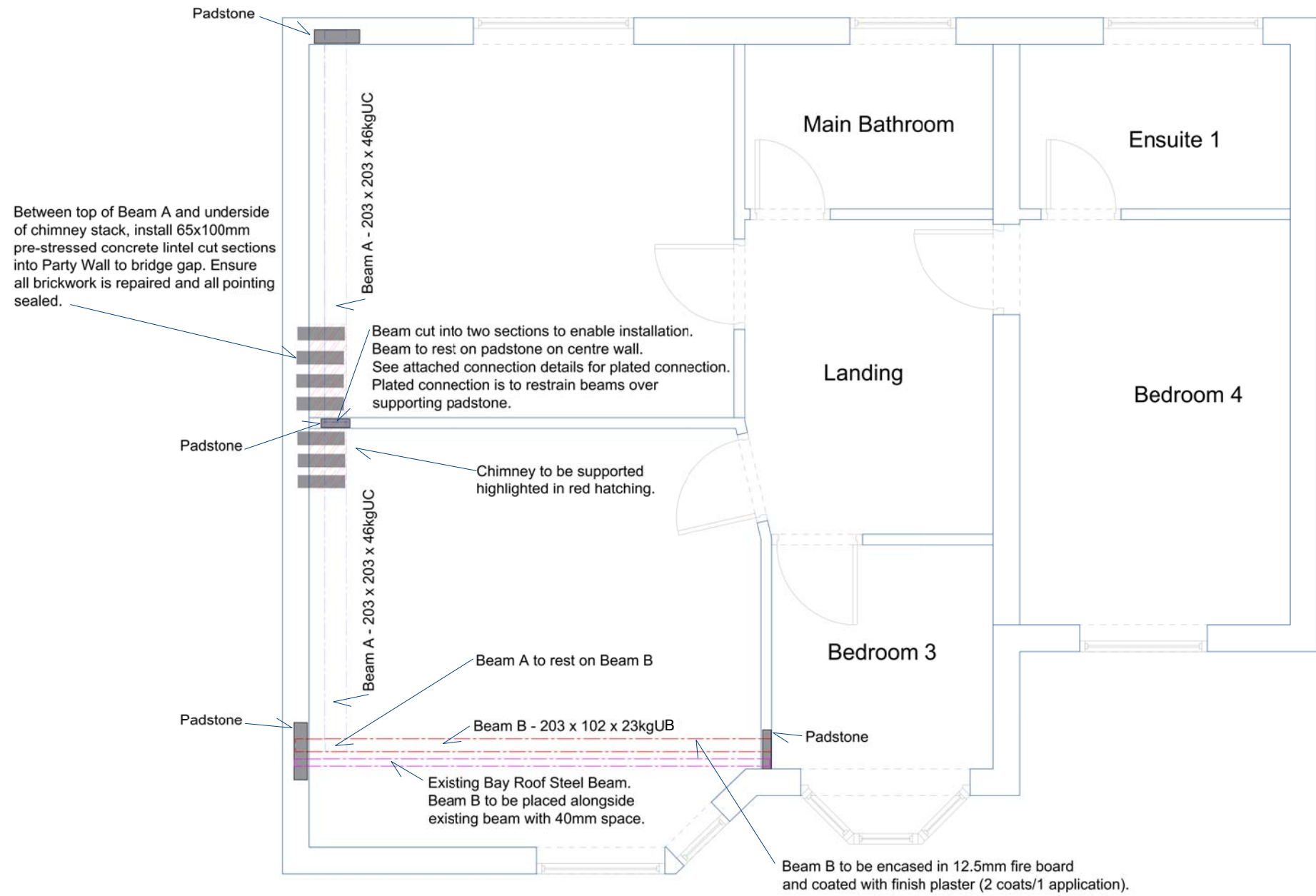

# Steel Beam Layout

CONTENTS			
Drawing Title	Page	Drawing No.	Rev.
Steel Beam & Structural Layout	1	PA-2023-44-1	

REVISION TABLE		
REV.	DATE	DESCRIPTION



**PlanningApplications.com**  
 Tel: 020 3294 9477  
 support@planningapplications.com  
 www.planningapplications.com  
 Summer House | Upper Court Road  
 Woldingham | Surrey | CR3 7BF

**PROJECT DETAILS:**  
 Mr. A. Mujir  
 12 Avondale Gardens  
 Hounslow  
 TW4 5HX

**DRAWING TITLE:**  
 Steel Beam & Structural Layout

**DATE:**  
 29/09/2023

**SCALE:**  
 A3 1:50  
 or as indicated

**SHEET:**  
 PA-2023-44  
**1**